

ADDENDUM 2

USC CloseHipp Building: Sprinkler Installation for 6th and 7th Floors
1705 COLLEGE ST. COLUMBIA, SC 29201
Project # 50003342-3 H27-Z387

A. NOTICE TO BIDDER

1. This Addendum is issued pursuant to the Conditions of the Contract and is hereby made part of the Contract Documents. The addendum serves to clarify, revise, and supersede information in the Project Manual, the Drawings, and previously issued Addenda. The Bidder shall acknowledge receipt of this Addendum in the appropriate space on the Bid Form. Failure to do so may subject the Bidder to disqualification. A list of attachments, if any, is part of this document.
2. The date for receipt of bids for this project is unchanged by this Addendum.

B. CLARIFICATIONS

1. **Replace** drawings A126 and A127 with attached revised drawings. Two additional fire hose cabinet openings on each floor are to be closed and finished.
2. A listing of responses to questions from Contractors and Suppliers are below:
 - a. What is the Sq. FT of each floor? *Refer to A126 and A127 floor plans to determine areas.*
 - b. Is there a service elevator available? *An elevator will be made available for the contractors use.*
 - c. Are there any operable windows, so we can create a trash chute? *There are no operable windows.*
 - d. Is there any insulation above the ceiling tiles? *Unnone.*
 - e. What is the height of the ceiling? *The majority on the ceilings are in the 9' to 10' range.*

END OF ADDENDUM #2

LEGEND

 HATCH INDICATES AREA OF WORK ON THIS FLOOR.

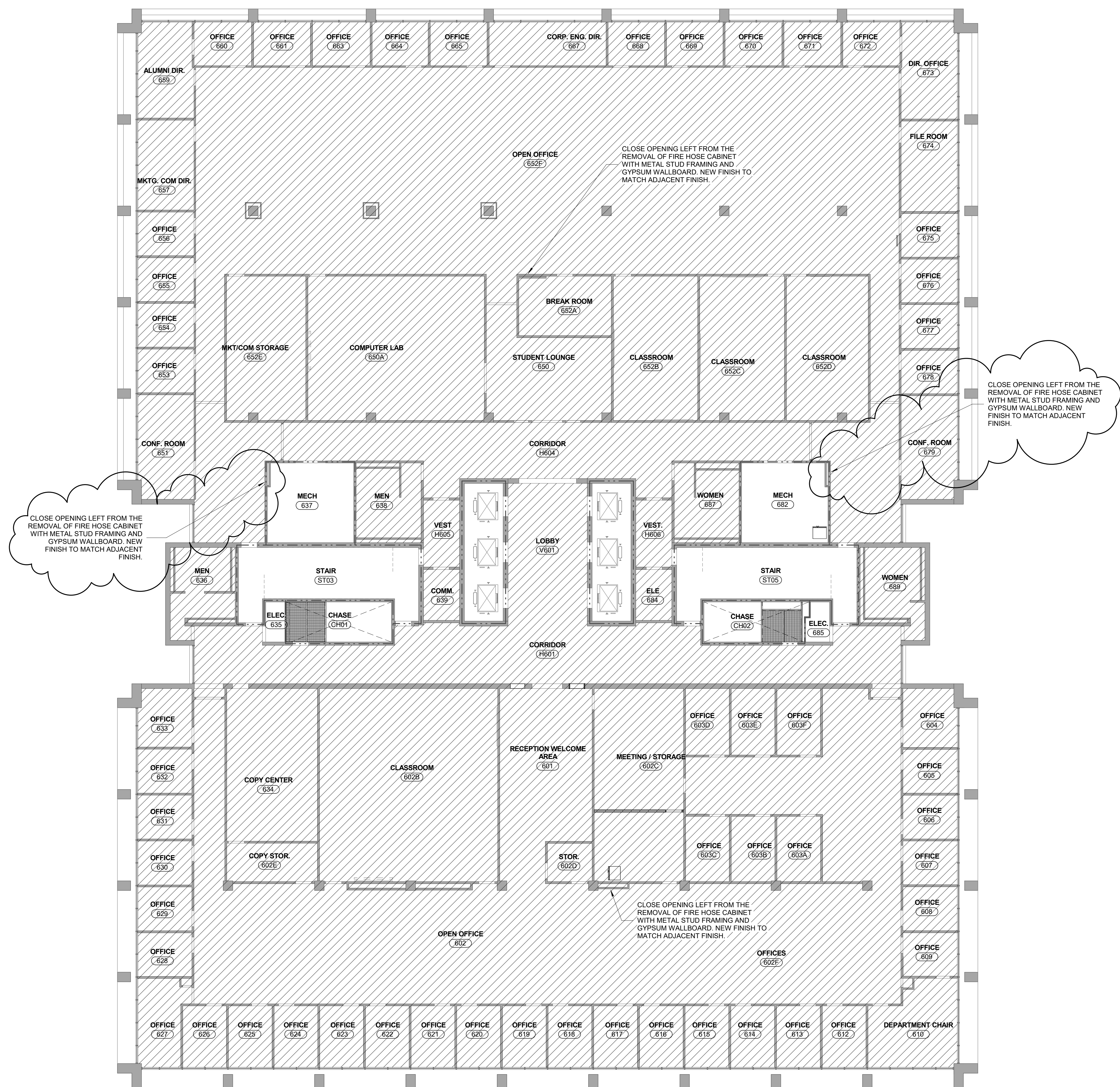

A1 6TH FLOOR RENOVATION PLAN
3/32" = 1'-0"

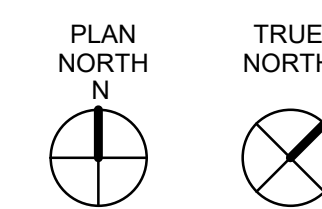

KEY PLAN

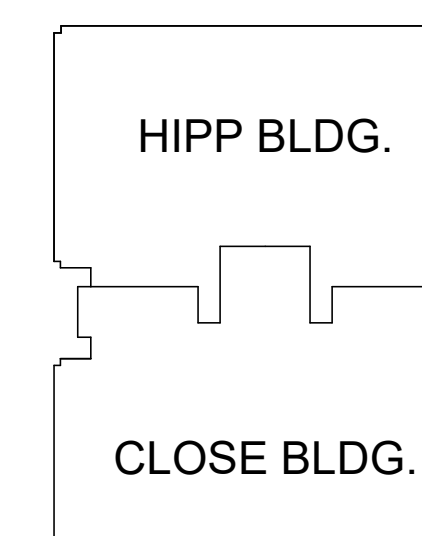

REVISIONS:

No.	Description	Date
1	Clarification	05/23/2019

PROJECT: 2202-186920
DATE: 04/29/19
DRAWN BY: Author
CHECKED BY: Checker

6TH FLOOR
RENOVATION
PLAN

LEGEND

HATCH INDICATES AREA OF WORK ON THIS FLOOR.

REVISIONS:

No.	Description	Date
1	Clarification	05/23/2019

PROJECT: 2202-186920
DATE: 04/29/19
DRAWN BY: Author
CHECKED BY: Checker

7TH FLOOR
RENOVATION
PLAN

E

D

C

B

A

5/23/2019 8:58:22 AM

1

2

3

4

5

6

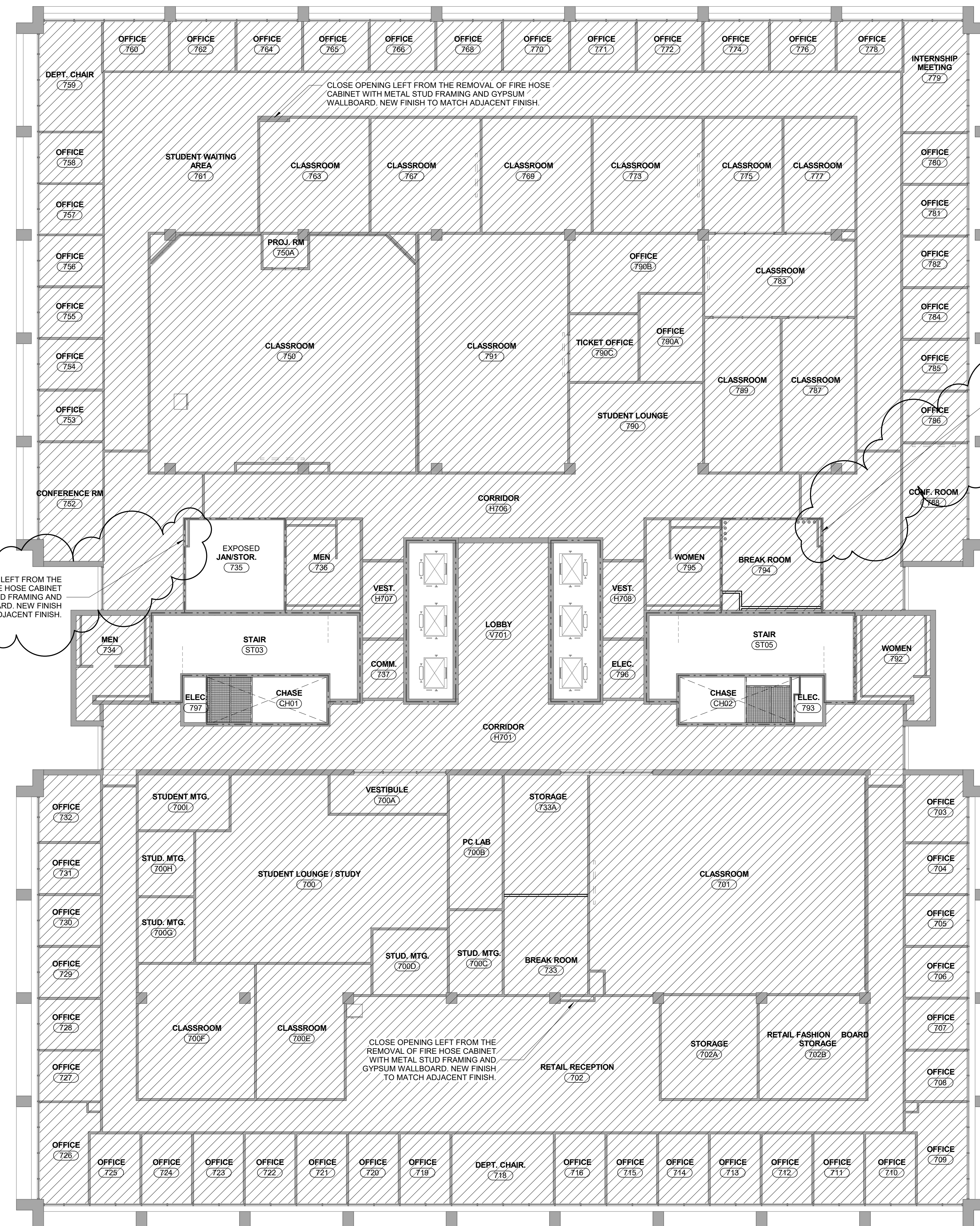

A1 7TH FLOOR RENOVATION PLAN
3/32" = 1'-0"

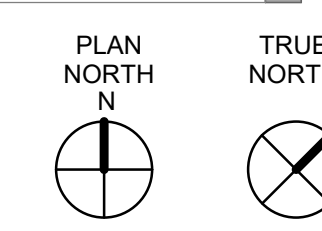

KEY PLAN

